

---

***AD-61***

—— CONTENTS ——

FIG.1 DUPLEX UNIT ..... 2

FIG. 1 DUPLEX UNIT

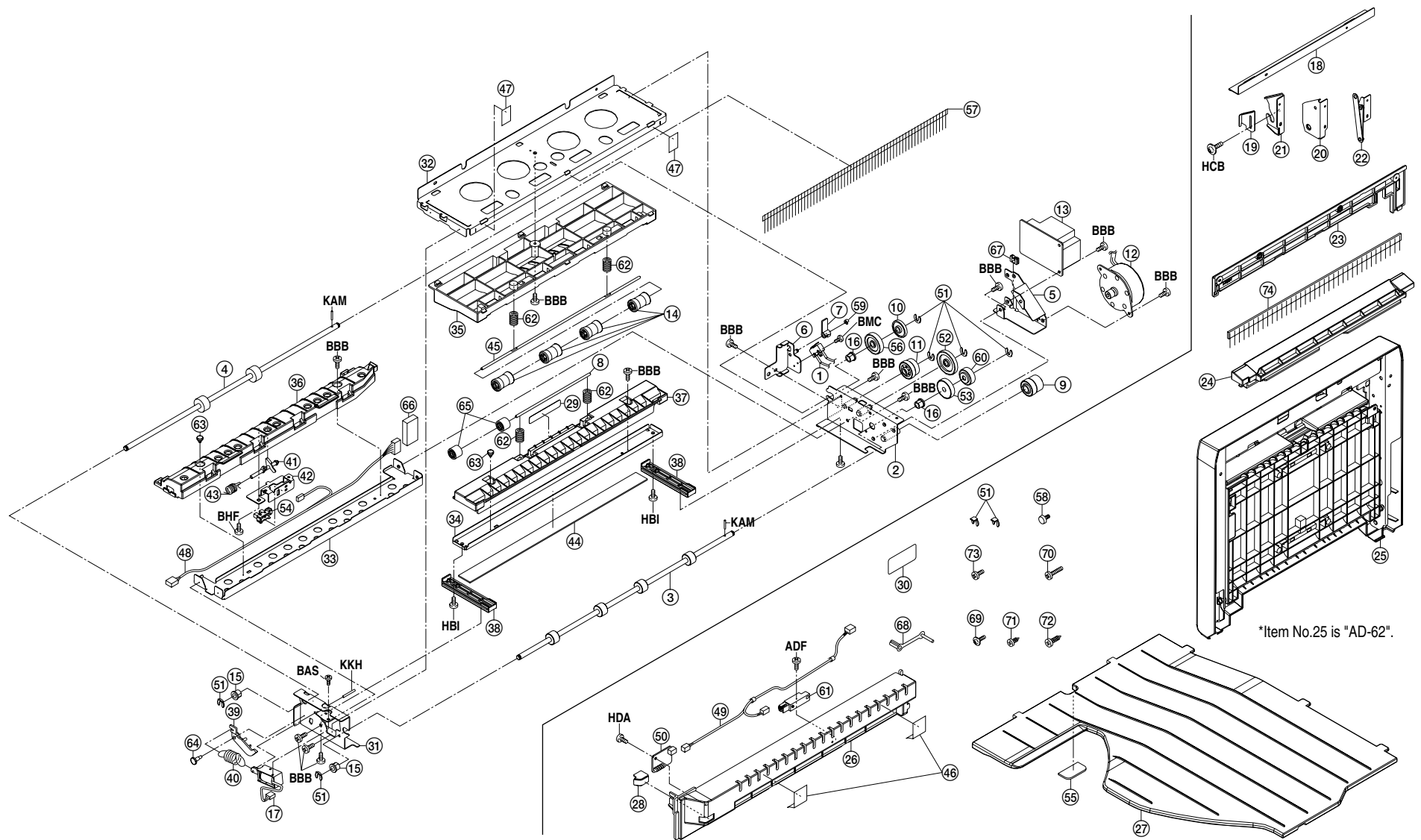

FIG. 1 DUPLEX UNIT

3A6

SP	Ref. No.	Part. No.	Description	Quantity		
				120V	230V	240V
●	1	3A601010	RELEASE SWITCH ASS'Y	1	1	1
	2	3A616010	REAR FRAME	1	1	1
●	3	3A616020	ROLLER,RIGHT EJECT	1	1	1
●	4	3A616030	ROLLER,LEFT EJECT	1	1	1
	5	3A616040	MOUNT,MOTOR	1	1	1
	6	3A616050	MOUNT,SAFETY SWITCH	1	1	1
	7	3A616060	LEVER,SAFETY SWITCH	1	1	1
	8	3A616070	SHAFT,EJECT PULLEY	1	1	1
	9	3A616080	GEAR,19/38	1	1	1
	10	3A616090	COLLAR,JOINT DUPLEX	1	1	1
	11	3A616100	GEAR 19/21	1	1	1
●	12	3A627010	MOTOR,MAIN	1	1	1
●	13	3A628011	MOTOR DRIVER PCB	1	1	1
	14	2AV20160	PULLEY,EJECT	4	4	4
	15	29806560	BUSHING 6	2	2	2
	16	29806810	BUSHING,6 REGISTRATION	2	2	2
●	17	3AZ21890	SOLENOID,FEED SHIFT	1	1	1
	18	3A402110	JUNCTION PLATE,DUPLEX	1	1	1
	19	3A402120	FRONT FULCRUM PLATE,DUPLEX	1	1	1
	20	3A402130	REAR FULCRUM PLATE,DUPLEX	1	1	1
	21	3A402140	FRONT HOOK,FULCRUM	1	1	1
	22	3A402150	STOPPER,DUPLEX	1	1	1
●	23	3A404040	LEFT COVER,MACHINE	1	1	1
	24	3A416100	GUIDE,FEED IN MACHINE	1	1	1
	25	3A458010	UNIT,HD,JPNC,100/60	1	1	1
●	26	3A804010	COVER,RIGHT EJECT	1	1	1
●	27	3A804020	TRAY,JOB SEPARATOR	1	1	1
●	28	3A804030	COVER,JOB SEPARATOR LED	1	1	1
	29	3A805020	LABEL,LOWER LEFT GUIDE	1	1	1
	30	3A805040	LABEL,JAM REMOVAL	1	1	1
	31	3A821010	FRONT FRAME	1	1	1
	32	3A821030	UPPER STAY	1	1	1
	33	3A821040	LOWER RIGHT STAY	1	1	1
	34	3A821050	LOWER LEFT STAY	1	1	1
	35	3A821060	UPPER GUIDE	1	1	1
	36	3A821070	LOWER RIGHT GUIDE	1	1	1
	37	3A821080	LOWER LEFT GUIDE	1	1	1
	38	3A821090	RAIL,LOWER LEFT GUIDE	2	2	2
	39	3A821120	LEVER,FEED SHIFT	1	1	1
	40	3A821130	SPRING,FEED SHIFT LEVER	1	1	1

SP	Ref. No.	Part. No.	Description	Quantity		
				120V	230V	240V
●	41	3A821140	ACTUATOR,EJECT	1	1	1
	42	3A821150	HOLDER,ACTUATOR EJECT	1	1	1
	43	3A821160	SPRING,ACTUATOR	1	1	1
	44	3A821170	SHEET,LOWER LEFT STAY	1	1	1
	45	3A821190	SHAFT,EJECT PULLEY	1	1	1
	46	3A821210	SHEET,COVER RIGHT EJECT	2	2	2
	47	3A821220	SHEET,UPPER STAY	2	2	2
	48	3A827010	WIRE,JOB SEPARATOR	1	1	1
	49	3A827020	WIRE,LED	1	1	1
●	50	3A828011	LED PCB	1	1	1
	51	34806150	STOPPER 5	8	8	8
	52	34920200	GEAR 30,IDLE EJECT	1	1	1
	53	34922570	GEAR 23,DEVELOPING	1	1	1
●	54	35327400	SWITCH,FEED	1	1	1
	55	35911350	PAD,ADF PAPER FEED	1	1	1
	56	36915350	GEAR 25,DEVELOPING	1	1	1
	57	63212210	STATIC ELIMINATOR,EJECT	1	1	1
	58	64007010	PIN,CLEANER	1	1	1
	59	65016080	STOP RING E3	1	1	1
	60	65922071	GEAR 18,DEVELOPING DRIVE	1	1	1
●	61	66006360	PAPER SWITCH	1	1	1
	62	68814720	SPRING B,DOCTOR BLADE	4	4	4
	63	48171300	PIN,TONER DISPOSAL TANK	2	2	2
	64	73912281	PIN,ORIGINAL HOLDER	1	1	1
	65	78710050	PULLEY LOOP SECTION	2	2	2
	66	J0144110	CASE,1-175694-1(AMP)	1	1	1
	67	M2104350	EDGING,EDS-0607M(KITAGAWA)	1	1	1
	68	M2105130	CLAMP,NDA-03(KITAGAWA)	1	1	1
	69	B4103050	TRIPLE SCREW M3X05 (CHROMIUM)	1	1	1
	70	B1103140	BINDING SCREW VM3X14(CR)	7	7	7
	71	B4143080	+TP TRIPLE TAP-TITE P SCREW M3X08(CR)	1	1	1
	72	B4144120	TRIPLE TAP-TITE P SCREW M4X12(CHROMIUM)	1	1	1
	73	B1303050	BINDING SCREW BVM3X5 (BLACK)	2	2	2
	74	18393020	PARTS,STATIC ELIMINATOR EJECT(SP)	1	1	1

- Parts with "●" are component parts or sub-assemblies of the assembly appearing immediately above them.
- Parts with "●" indicates the Service parts.